

Huntington Community Primary School,
Aldford Road,
Huntington, Chester, CH3 6EA.

Telephone: 01244 506450
admin@huntington.cheshire.sch.uk
head@huntington.cheshire.sch.uk
www.huntington.cheshire.sch.uk

September 5th, 2023

Dear Parents/Carers

Welcome back after what I hope has been an enjoyable summer for you all. We are looking forward to working with the children once more, in particular using our new art scheme of work, with all teachers having received expert tuition from art adviser Julie Mitchell today, and a bespoke scheme of work having been devised with Julie in the summer term, based on her new publication *The Art Tree* – more about this in due course.

Congestion outside school

As you will no doubt be aware, the bridge modifications and consequent lane closure/traffic lights are having an enormous impact on traffic in the area. Please anticipate increased journey times and plan accordingly.

In an effort to reduce congestion, for the remainder of the bridge work (four weeks approx.)

- **junior (Y3-6) parents/carers may drop off their children directly from cars in the school drop-off zone from 08:30** and
- **other parents/carers may also access the site from 08:30** (although those parents/carers will need to stay with their children on-site until school opens at 08:45).

The best way to reduce vehicle congestion, of course, is to walk to school, but please be aware that the temporary pedestrian crossing at the city end of the bridge is very, very slow to cross (approx. 8 minutes between crossings, with 4-way lights in operation).

Parking in the area

Please also note that Butterbache Road has cones placed down the road and therefore parking anywhere at the waterworks/south end of that road may cause problems. The Parish Council invite you to use the Jubilee field car park for the duration of the bridge works instead.

Leave of Absence

Please remember that requests for *Leave of Absence* during term time must be made using the appropriate form, available online (*Parents page, Forms*) and from the school office, and must be submitted at least two weeks prior to the start of the period requested.

Such requests will be authorised only in 'exceptional circumstances', as defined by the government, and parents may receive a Fixed Penalty Notice for an unauthorised absence of 5 school days or more.

These regulations only apply once a child has reached statutory school age (5 years old), but we would still appreciate completion of the relevant form by Nursery parents and parents of Reception children who are still only 4, to assist the office staff.



ACCESS TO THE BUILDING

START OF DAY (08:45 ONWARDS – site access from 08:30 until bridge work finished)

No ball games are allowed before school due to the class lining up positions.

CLASS LINING UP

See red class lining-up positions as indicated below; green arrows show the access routes into the building.

Nursery and Reception classes will line up alongside the picket fence surrounding the Early Years canopy.

Year 1/2 will line up facing their classroom doors

Year 3-6 will line up facing the building on the marked pitches – positions are indicated by class name signs.

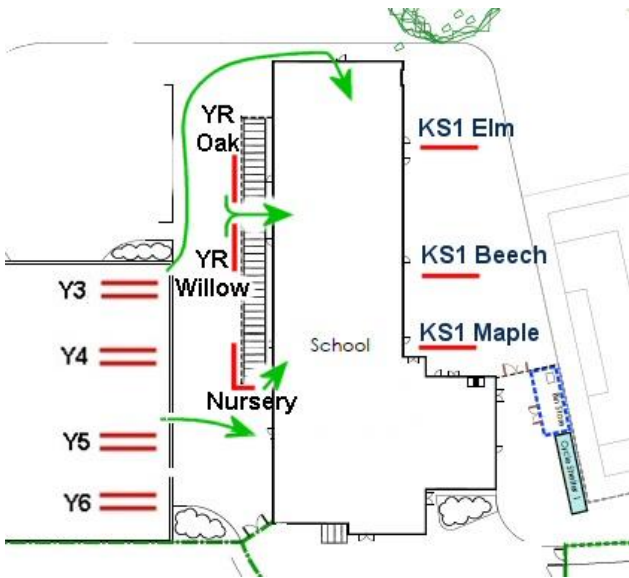

POOR WEATHER

If conditions demand, children will be allowed into the main building from 08:30 onwards.

Nursery, Reception and Y1/2:

enter by their usual doors

Y3/4 enter at their usual staircase.

Y5/6 enter at their usual staircase.

END OF THE DAY

Children will be collected either from doors into the main building or from the Early Years canopy area, as indicated below:

2:55 Nursery children collected from Nursery gate

3:15 Y1/2 children collected from their classroom doors on KS1 side

Reception children collected from canopy area gates

3:25 Y3/4 children collected from classroom doors on KS1 side (as shown)

Y5/6 children collected from staircase doors on KS2 side (if not walking home by themselves)

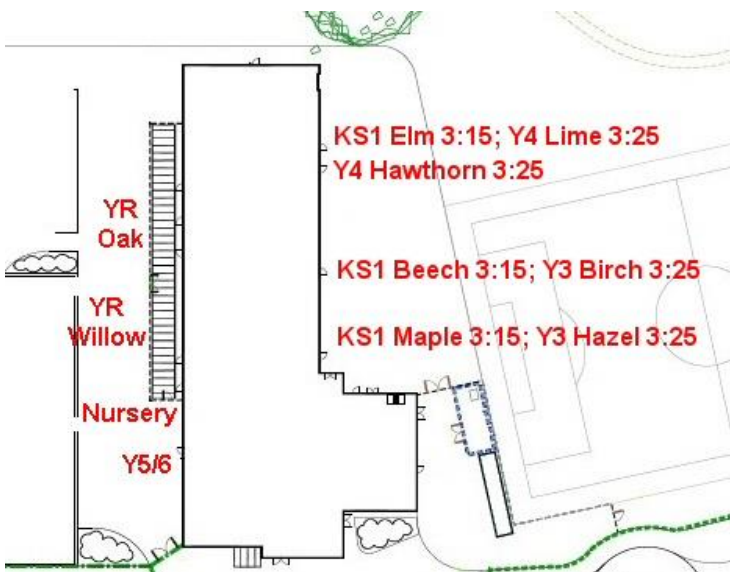

NURSERY – lunchtime changeover

11:55 Children leaving/arriving should do so via the Nursery gate.

Kind regards

Mr Rose
Headteacher